

AYO ULTRASONIC KITCHEN SINK

MANUAL



Dear user:

Thank you for choosing SAYO Ultrasonic Kitchen Sink !

In order to have a smoothly installation, please read this manual carefully before installation and keep it properly for future reference.

Product Profile

SAYO Ultrasonic Kitchen Sink can effectively clean and purify all kinds of food, dining ware, ornaments, and the like. Based on an original highly effective frequency conversion technology, its frequency and operating mode can be adjusted to the optimal state by automatically matching objects to be cleaned inside the sink. High-frequency energy released in water can thoroughly clean different numbers of items at different water levels without any residual at a vibration frequency of 30,000-40,000Hz.

Product Features

- Residual pesticides and fertilizers on fruits and vegetables are effectively removed;
- Required only clean tap water to wash the tableware, free of any detergent;
- Dirt, parasite and worm eggs on fruits, vegetables and marine products are all removed effectively;
- Bacteria, viruses and microorganisms on the surface of foods and tableware are removed effectively.

Product Characteristics

- Environment friendly
Only water is needed, free of any chemical substances cleaner
- Cleaner
Cleaning deeply to effectively remove pesticides, germs and grease etc.
- Intelligent
Based on a microcomputer intelligent control system, multiple modes are available to meet different functions of cleaning.

Before Installation



Warning! Please wear gloves during operation, and be careful with the edge of the sink to avoid scratching.

- Please follow your regional pipeline and building standards.
 - Do not power on before a water filling test.
 - Do shut off cold/hot water supply.
 - Please unpack the product before installation and check whether it has been damaged.
- The box inside includes the items as follows:

	Name	Quantity	Remarks
1	Intelligent and ultrasonic sink body	1	
2	Intelligent driver	1	
3	Electric Power Cable	1	Exclusive for the intelligent driver
4	Strainer	1	Exclusive for the Intelligent and ultrasonic sink

- Check water supply and drainage pipeline. If needed, please change the pipeline.
- All data in this manual are provided according to the latest product data before its publication.

Tools Recommended



Safety glasses



Cross screwdriver

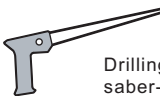
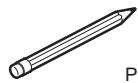

Tapemeasure

Drilling saw or
saber-toothed saw

Pencil



Gloves



Drill



Jigsaw

Product Specification

Model	Rated Power	Voltage	Dimension (mm)	Template cutting size (mm)
Innova DBC	350W	220V/50HZ	850x460	820x430
Innova DBC	350W	220V/50HZ	520x460	490x430

Installation Instruction

1. Hole cut-out

- Mark it out in a position with a proper distance from the cabinet by referring to technical parameters in this manual, as shown in Figure (1).
- Use a drill machine to form an opening on the table, as shown in Figure (2).
- Put the sink in the opening to check whether the opening is appropriate; if the size of the opening is suitable, please clean up the dust and sundries on the table and put it aside.

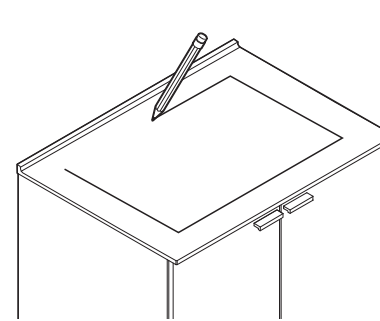

Figure (1) Marking out on the kitchen board

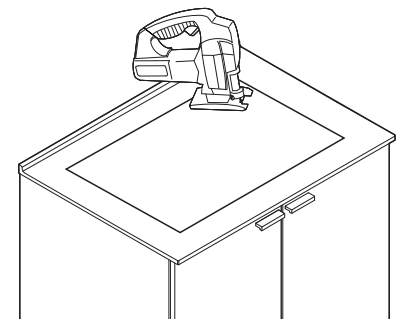
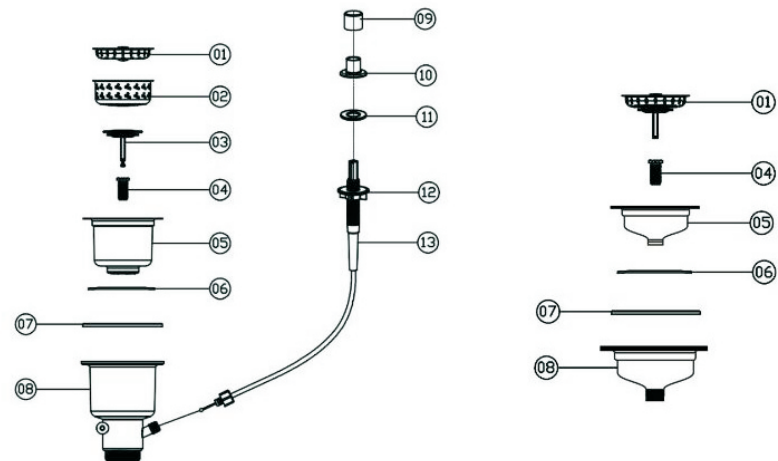

Figure (2) Opening with a drill tool

2. Strainer Installation

There are two different type of strainer for the Intelligent and ultrasonic sink, one is Remote control strainer, the other is non-remote control strainer. . Installation methods of both types of drainers are the same. For specific structures of them, please see Figure (3).



Remote control strainer

Non-remote control strainer

No.	Name
01	Drainer component
02	
03	
04	Screw
05	Strainer bowl
06	Seal
07	Bottom Seal
08	Waste Bowl

No.	Name
09	Button
10	Switch pedestal
11	Spacer
12	Plastic nut
13	Remote control switch
001	Steel wire ball head
002	Drawing pin
003	Adjusting screw

Figure (3) The intelligent and ultrasonic sink's strainer parts

3. Installation Method and Steps

- Take out the drainage components (01-03) of the strainer, and unscrew the screw (04) in the strainer bowl (05).
- Set the seal (06) around the strainer bowl (05), then put it in the corresponding **drainage opening of the sink**.
- Set the bottom seal (07) and the waste bowl (08) successively on the back of the sink, and insert the screw (04) to the interior of the sink and spin to tighten it.

In the case that non-remote control strainer is installed, the installation is completed. However, if you need to connect a remote control strainer, please continue the following steps:

- The remote control switch (13) going through the installation opening and the spacer (11) is connected with the switch pedestal (10) and the plastic nut (12), and then screwed to be fixed.
Note: the spacer should be above the table.
- Pull the drawing pin (002) back to a catching groove (as shown in Figure (4)-1), and embed the steel wire ball head (001) into the steel wire groove (as shown in Figure (4)-2), and finally pull back drawing pin (002) and fasten the steel wire (as shown in Figure (4)-3).
- Press the switch installed down to extend the steel wire from one end.
- Install the drainage components in the sink according to installation instructions related.
- For specific component names and serial numbers, please refer to Figure (3).

Note: For sealing failures, please screw the adjusting screw (003) lower. For excessively small drainage, please screw the adjusting screw (003) higher.

Please keep in mind that do not screw the adjusting screw too high or low to make it fail to contact the drawbar (03), in which case, the switch cannot realize the sealing or draining. After adjustment, please screw the nut on the component tightly to prevent loosening.

4. Intelligent Driver Installation

- Put the sink to an opening on the cabinet table.
- Plugs of two cables of the sink are plugged into the sockets of the driver respectively and locked, as shown in Figure (5).
- Connect the cables to the driver, as shown in Figure (6).

Note: Please put the intelligent driver into the cabinet, and at least 10cm away from the bottom of cabinet.

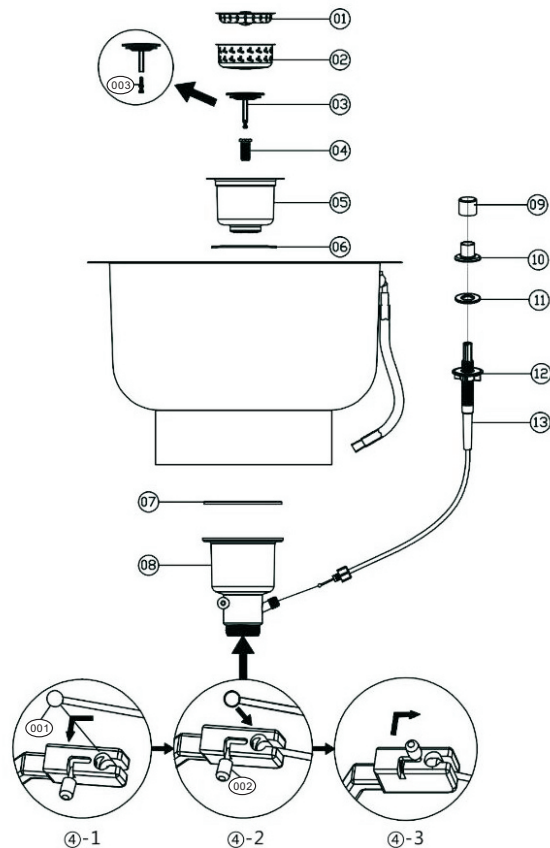

Figure (4) Diagram of the remote control strainer

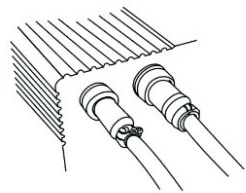

Figure (5) Cable Installation

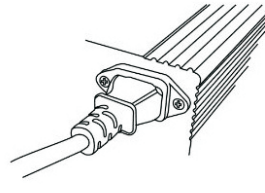

Figure (6) Power Line Installation

5. Adjustment and Water Testing

- Adjust the tap to observe whether any leaks occurred.
- Adjust the strainer:
Press down the drainer button for making the strainer to a state of water storage, and inject water into the sink bowl to observe whether any leaks occurred.
Press down the drainer button for making the strainer to a state of water drainage to observe whether the sink drains smoothly;
Adjust the adjusting screw (003) with reference to Figure (4) according to the observation.

6. Sink Fixation

- After the completion of testing, waterproof glue is applied around the edges of the sink to fix it and prevent water seepage on the table.
- Fix the intelligent driver on and inside the cabinet, and at least 10cm away from the bottom of the cabinet.
- After installation, it should be as shown in Figure (7).

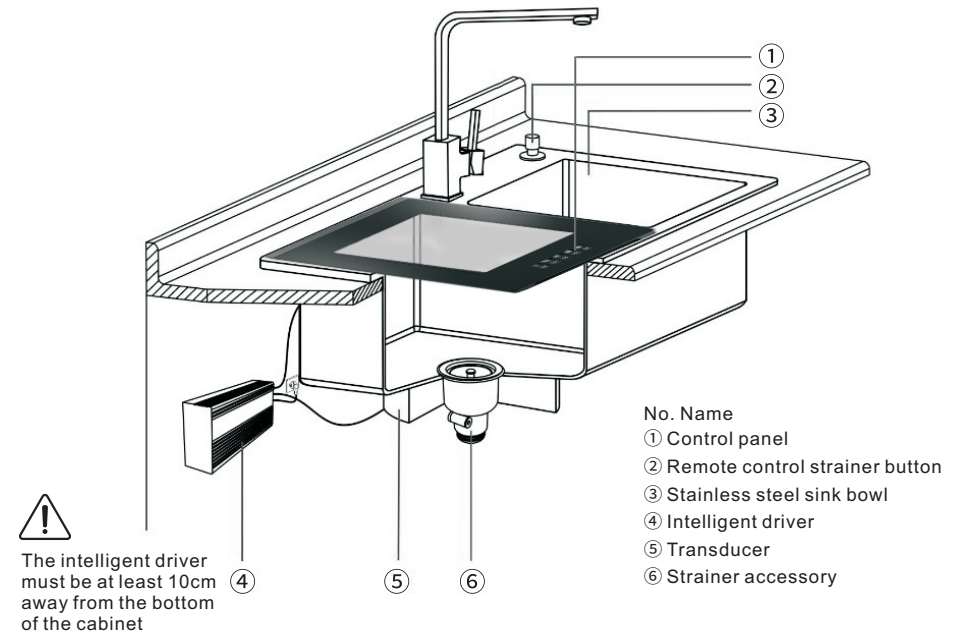
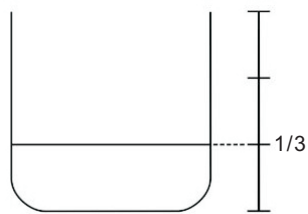

Figure (7) Assembly Diagram of Intelligent & ultrasonic sink

Direction for Use

1. Operation method and steps

- Check: Whether the strainer for the Intelligent & ultrasonic sink is in a state of water storage; Whether the intelligent driver of the sink is electrified.
- Turn on the tap to inject at least 1/3 water of the sink; for the specific amount of water, it depends on the number of items to be cleaned.



Please do not start the Intelligent & ultrasonic sink when there is no water in it.

Note: For dirt that is difficult to remove, please dip it for a while before cleaning to achieve a better effect; or, you can put it in warm water.

Figure (8) Minimum Water Level Requirement and Suggestions

- Put items to be cleaned in the Intelligent & ultrasonic sink, and the objects should be in contact with water; please do not stack them, as stacking may affect the cleaning effect.
- Start the Intelligent & ultrasonic sink by an operation panel. The layout of the operation panel is shown in Figure (9) below.

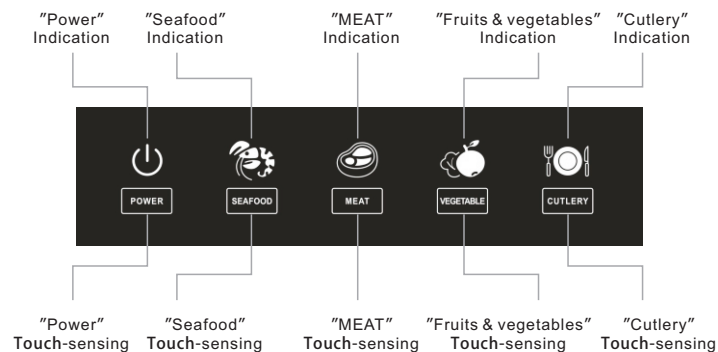

Indication area:
If the light of an indication area goes on, it indicates that the corresponding function button has been initiated

Touch-screen area:
It is for touch control and initiating the corresponding function button

Figure (9) Schematic Diagram of Operation Panel

How to use the Intelligent & ultrasonic sink function through the operation panel? Refer Figure (10).

- 1) Turn on "Power": Keep pressing the "Power" sensing position for 1 second to turn on the power, and the light of the "Power" indication area on the operation panel is on.
- 2) To start a function: After the light of the "Power" indication area is on, touch a function button according to the object to be cleaned, and the corresponding indication area lights up; in this case, other function buttons in addition to the "Power" button are locked and have no response to any touch, and the cleaning starts.
- 3) Stop Cleaning: If you need to stop the cleaning in this process, please touch the corresponding function button again so that the corresponding indication area darkens and the cleaning is discontinued. After one minute, the sink will be shut off automatically.
- 4) End of cleaning: After the completion of cleaning, the corresponding indication area automatically darkens, and you can touch the "Power" button to power off; or, wait for 1 minute until the sink's power is shut off automatically.

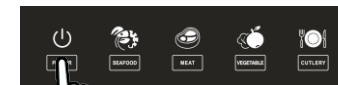

1) Turn on "Power"

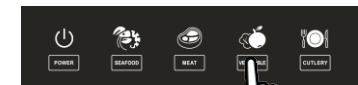

2) To start a function

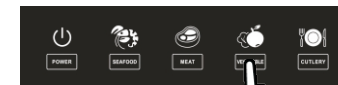

3) Stop Cleaning

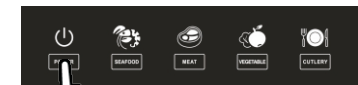

4) End of cleaning

Cautions

In order to protect you and your family from being injured or financial losses, please read the following details carefully before using the water tank, to ensure correct and safe operation.

- Power socket of intelligent & ultrasonic sink must be reliably grounded.
- Only the voltage indicated on the apparatus is applicable to the intelligent & ultrasonic sink, and please makes sure that the voltage conforms to relevant safety standards.

- Please do not touch its plugs with a wet hand in case of electric shock.
- The intelligent & ultrasonic sink is strictly forbidden from being started in a case of no water, as such an operation may affect its service life.
- During the cleaning, if the intelligent & ultrasonic sink stops, and the light of the "Power" indication area flashes in the meantime, please shut it off and restart later for cleaning. In a case that the above situation takes place repeatedly, please cut off its power source and contact an authorized service center.
- Please do not disassemble the intelligent & ultrasonic sink by yourself.

DAILY MAINTENANCE & CARE

SAYO uses only highest quality stainless steel of alloy grade 18/8 (AISI 304) this means with roughly 18% chromium and around 8% Nickel, to satisfy the highest possible standards.

Stainless Steel integrates beautifully in any kitchen environment – better than almost any other material with its properties-

- Classic timeless aesthetic
- Rust Proof
- Completely Heat Resistance
- Suitable For Food Use and Hygienic
- Stain & Acid Resistance
- Non Fading
- Easy to Care For

Every product has limitations and in time may deteriorate from handling, cleaning or exposure to atmospheric conditions such as extreme climate, pollution and proximity to salt water, humidity and ultraviolet rays. Eventual tarnishing is therefore, not a perfect, but a normal process, which is unavoidable. Proper care as below would ensure that these products last a longer period for its aesthetic and usage.

1. Clean the sink once in a day. For cleaning, use mild soapy water and rub in the direction of grain lines, rinse and towel dry.
2. Avoid use of cleaners and bleachers containing harmful chemicals and acids.
3. Steel wood/ wired brush/ abrasive sponge pads are not recommended for cleaning as it leads to scratches and rusting on the sink, instead use soft household sponge or cloth.
4. Drying is very important to eliminate the collection of lime scale, mineral deposits and calcium stake.

5. Always rinse the sink after every use and wipe dry.
6. Avoid prolonged contact with citric or high salt concentration food as it can lead to staining, pitting and corrosion of the sink.
7. Prolonged exposure to direct sunlight will lead the film coating to stick to the sink and may be difficult to remove later.
8. Stubborn stains from hard water's salt particles deposits can be removed by pouring a little warm vinegar based cleaner into the sink and allow it to sit for a few minutes. Rinse with clean water and dry.
9. Please be particularly careful for knives and sharp objects during cleaning to avoid damaging the sink surface.
10. remove all traces of cement, mortar, lime, POP, etc. used during installation as it can lead to surface rusting or pitting.
11. Gently open & close door cover. Avoid to put heavy things or impact of any hard object on sink cover as it may damage the cover as well as touch panel.
12. Power socket of intelligent & ultrasonic sink must be reliably grounded.
13. Only the voltage indicated on the apparatus is applicable to the intelligent & ultrasonic sink, and please makes sure that the voltage conforms to relevant safety standards.
14. Please do not touch its plugs with a wet hand in case of electric shock.
15. The intelligent & ultrasonic sink is strictly forbidden from being started in a case of no water, as such an operation may affect its service life
16. During the cleaning, if the ultrasonic sink stops, and the light of the "Power" indication area flashes in the meantime, please shut it off and restart later for cleaning. In a case that the above situation takes place repeatedly, please cut off its power source and contact an authorized service centre.
17. Operate touch panel buttons gently.
18. Check for proper electrical connections before switch on of ultrasonic function.
19. Avoid repeatedly ON-OFF of power supply within short span of time.

